

Status Indicator

Wash Dry
Sanitize

88

Water-intake Fault Indicator

Program Button

AUTO Quick Sanitize Dry Start/Pause
long touch OFF

The status indicator will flash for a few minutes to show that a program has been started.

Water tank cover

Make sure the top cover presses the red switch down

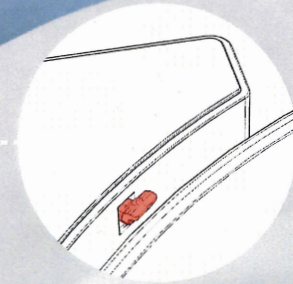

Warning hot steam

Fill the tank with clean water
Be sure to MIN & MAX fill line



Caution hot
Don't touch!



Don't fill water
in the glass tub!



Keep
children away



Soft water
inlet best



Auto
drystorage



Don't stick
to glass wall



Dishwasher
detergent only



Remove scale
with CH_3COOH

BABY BOTTLE WASHER

Operating Instruction



Modle	A1
Capacity	4 Sets
Power voltage	220V~ 60Hz
Current	10A
Rated power	780W
Water consumption	3.6L
Energy consumption	0.36kWh (AUTO)
Net weight	5.2Kg
Gross weight	6.8Kg

CONTROL PANEL & PROGRAM OVERVIEW

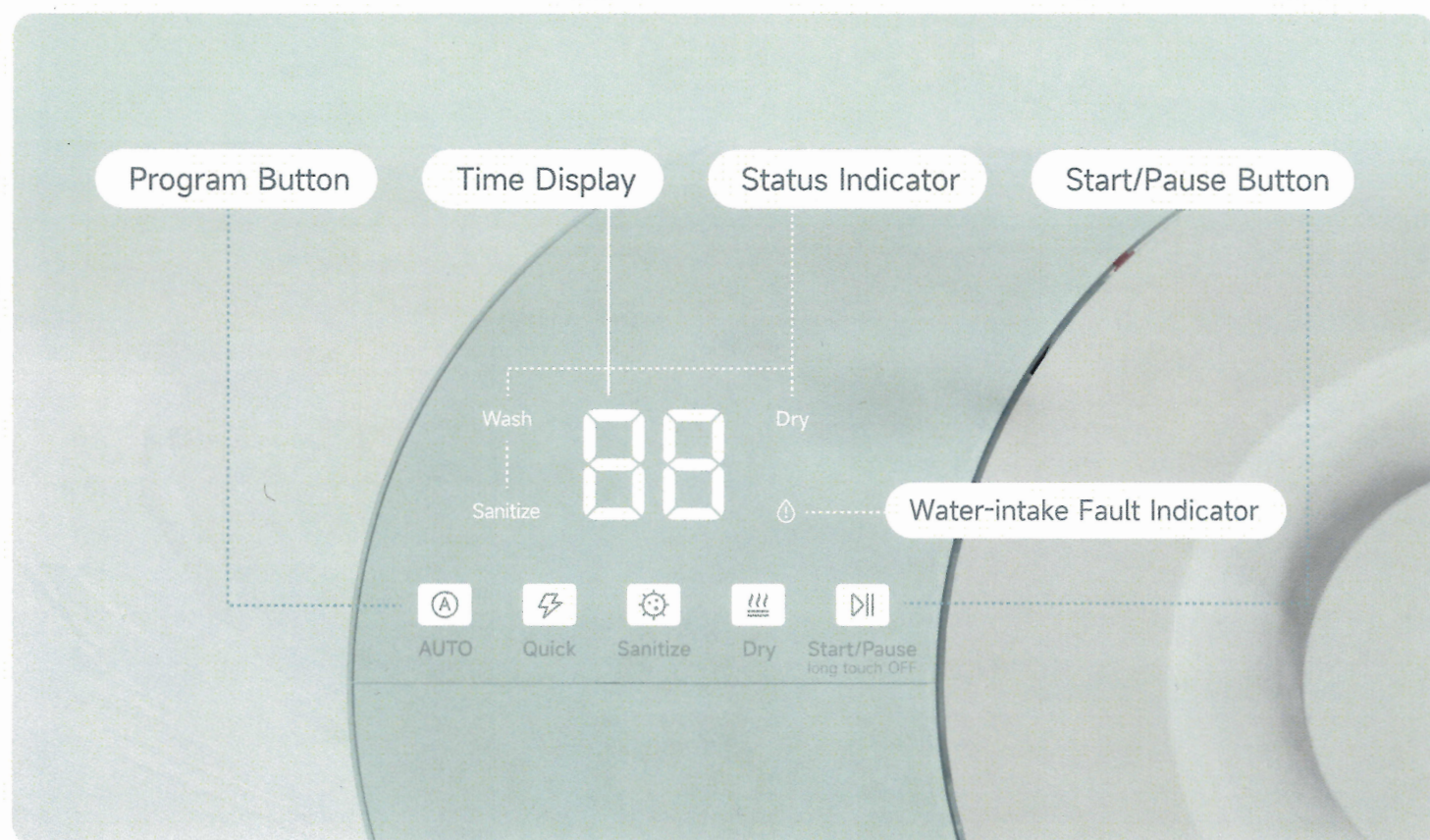

Program	Duration	When to use	Program sequence	Detergent	Water
AUTO	99min	Need deep wash & sanitize	Wash · Rinse · Sanitize · Dry	4-6 (g)	3.6 (L)
Quick	30min	Fresh soil for wash only No need Sanitize & Dry	Wash · Rinse	4-6 (g)	3.6 (L)
Sanitize	90min	Need Rinse & Sanitize	Rinse · Sanitize · Dry	/	3.6 (L)
Dry & Keep clean	(72h)	For Hand wash dry and keep clean for storage	Dry	/	/

SET UP & USE

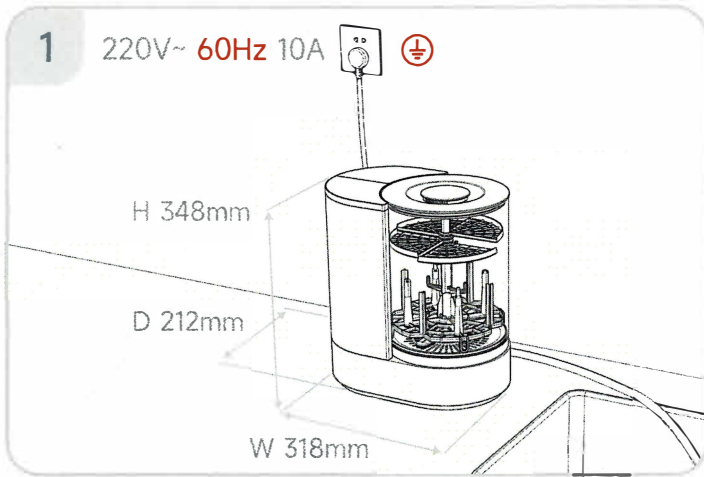

Place the baby bottle washer on a clean, dry, level surface. Put the drain pipe to the kitchen sink. Power the plug.

Far away from open fires or other appliances that give off heat. The appliance must be grounded. Make sure the drain pipe keep level. Do not raise the drain pipe.

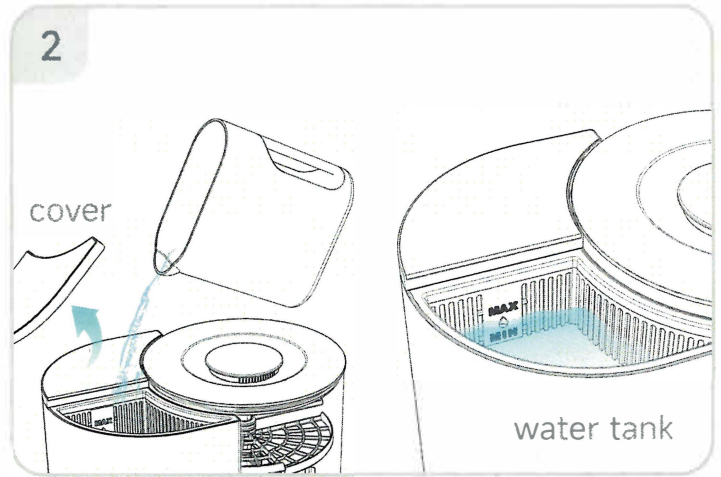

Open the water tank cover on the left side top of the appliance.

Fill the tank with approx. 3.6L fresh clean water. Be sure the water level is between MIN & MAX.

⚠ Please DO NOT fill water to the glass tub.

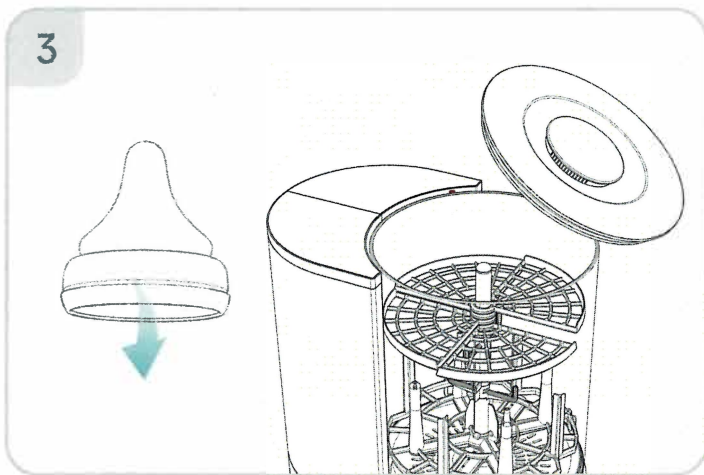

Remove milk and coarse food residues from milk bottles. Open the glass load cover, place the bottles and other washing parts.

Do not place the items where they will cover one another.

Load the items so that water can access all surfaces. This ensures that they get properly cleaned.

Make sure that all items are securely positioned, no one will fall to block the rotation of spray arm, no one will retain residual water.

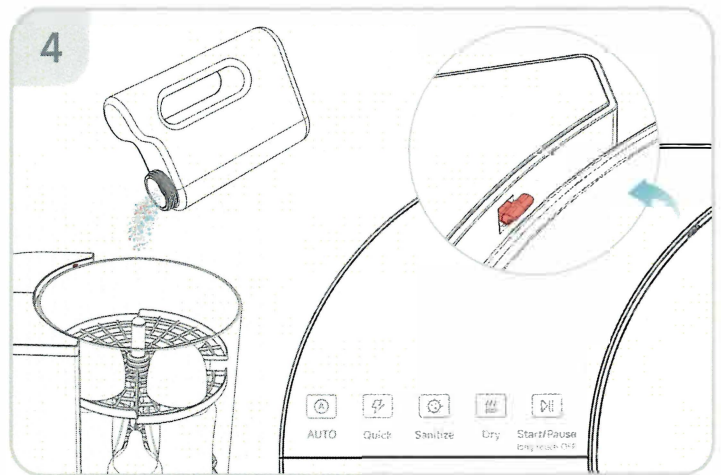

If using detergent only use 4-6g of Lina Leo universal detergent when use "AUTO" and "Quick" programme.

Close the top cover, be sure pressed the red switch down.

Touch any button turn on, select the program, then start the cycle.

⚠ ONLY USE Lina Leo Detergent, as other detergents contain harsh chemical which will damage the machine voiding warranty

LOAD THE ITEMS



**Dirty side tilts downward.
Concave surface tilts downward.**

Water spray from bottom up, be sure easy to enter the dirty side and easy exit, no retain residual water.

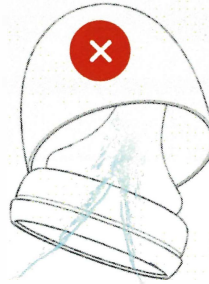

Do not place the items where they will cover one another.

Load the items so that water can access all surfaces. This ensures that they get properly cleaned.

Upper racks are used to load covers, spoons etc.

Bottle nipple can be hung diagonally, on the middle hook, or the raised bracket of the bottom rack.

Spray arm

The spray arm must not be blocked.

The upper rack can take off or fold.

High bottles or water cups can load inside.

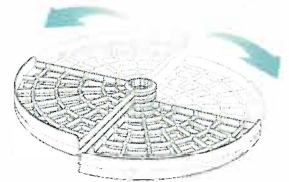

The bottom rack has 4 intensive column, with 2 thin head and 2 thick head.

They are used for load milk bottles, where can get better cleaning and drying performance.

Thin head can also use for cleaning water cup straw.

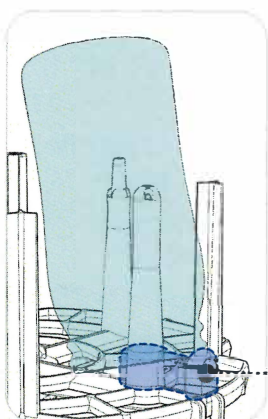

There are 4 bottle mouth support, they can make the bottle tilt, efficiently prevent residual water at the bottom of the bottle.

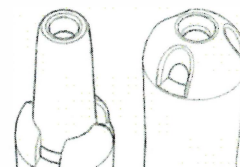

⚠ Caution

Not suitable items: wooden parts, plastic items that are not heat resistant, silverware etc.

Knives and forks, pay attention to the sharp tip down.